

MUSICA™ Application Note

Musica with Media Server

The
IP-Based
Distributed
Entertainment
Company.

Products Included:

Musica MU4602 System

or

Musica MU5066 System

Introduction

Adding a media server to the *Musica* system can greatly enhance the listening experience by allowing you to navigate through the music on a TV screen and select play lists, genre, or other options. Figure 1 depicts a media server connected to a *Musica* system.

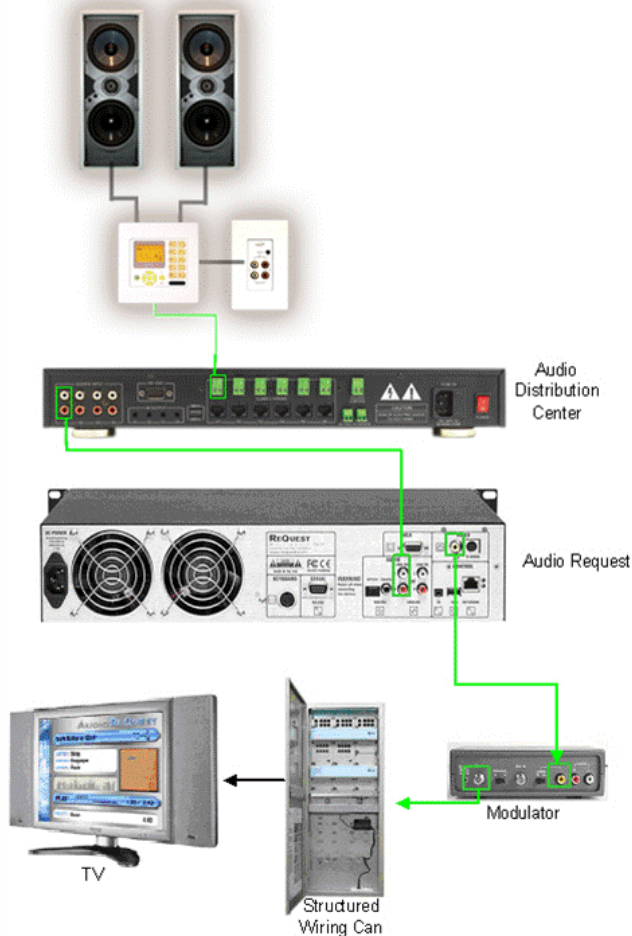

Figure 1 Media server connected to a *Musica* system



Connections

1. Connect the audio outputs of the media server to one of the source inputs of the MU5066ADC.
2. Connect the video output of the media server to the modulator.
3. Select a channel to view the media server's video output.

NOTE: In the menu of the media server, you may need to select NTSC or Pal (depending on the format used at your location).

4. Attach a coax cable to the RF output of the modulator and connect it to the designated input at your structured wiring center.

NOTE: You must know the specs of the cable amp being used to determine if you need to set the channel of the modulator above 117.

5. Connect the IR emitter from the front of the media server to the designated IR input on the back of the MU5066ADC.

NOTE: This allows you to control the media server remotely.

6. Learn the media server IR codes into the keypad.

Testing

To ensure that all connections are made and the system is correctly programmed, view a TV to see if the media server data is displayed and verify that you can navigate through the menus with the *Musica* keypad.